

FASTENER SEQUENCE @ EAVE

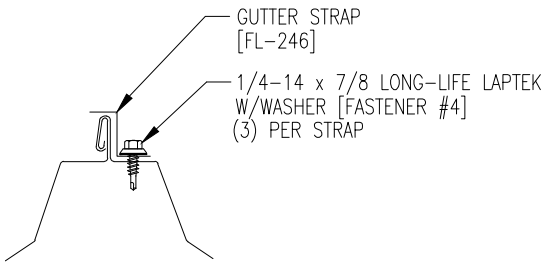

MINOR RIB TAPE SEALER AT ALL MINOR RIBS [HW-512]

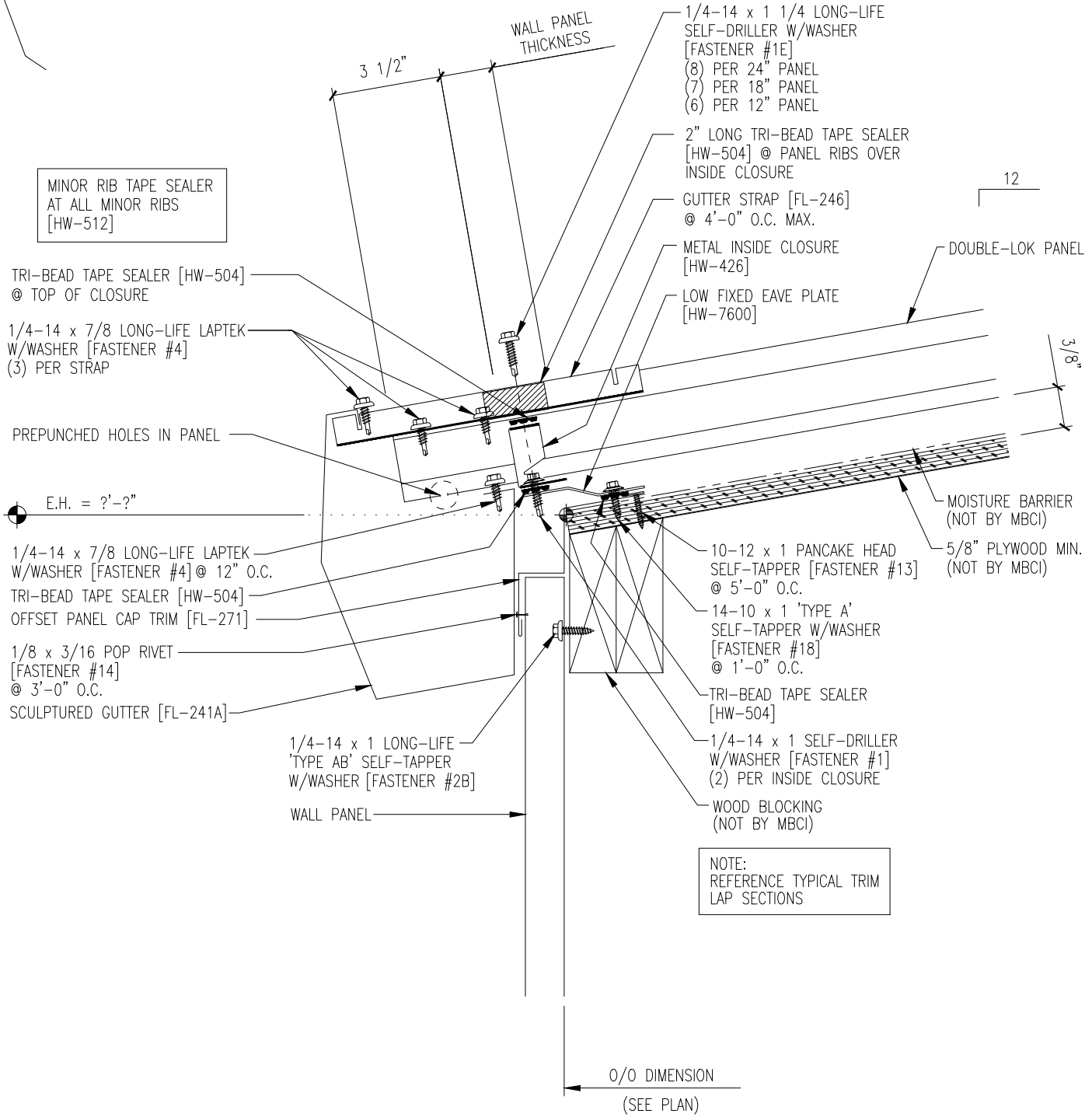

TRI-BEAD TAPE SEALER [HW-504] @ TOP OF CLOSURE

1/4-14 x 7/8 LONG-LIFE LAPTEK W/WASHER [FASTENER #4] (3) PER STRAP

PREPUNCHED HOLES IN PANEL

E.H. = ?'-?''

1/4-14 x 7/8 LONG-LIFE LAPTEK W/WASHER [FASTENER #4] @ 12" O.C.

TRI-BEAD TAPE SEALER [HW-504]
OFFSET PANEL CAP TRIM [FL-271]

1/8 x 3/16 POP RIVET [FASTENER #14] @ 3'-0" O.C.

SCULPTURED GUTTER [FL-241A]

1/4-14 x 1 LONG-LIFE 'TYPE AB' SELF-TAPPER W/WASHER [FASTENER #2B]

WALL PANEL

1/4-14 x 1 1/4 LONG-LIFE SELF-DRILLER W/WASHER [FASTENER #1E] (8) PER 24" PANEL (7) PER 18" PANEL (6) PER 12" PANEL

2" LONG TRI-BEAD TAPE SEALER [HW-504] @ PANEL RIBS OVER INSIDE CLOSURE

GUTTER STRAP [FL-246] @ 4'-0" O.C. MAX.

METAL INSIDE CLOSURE [HW-426]

LOW FIXED EAVE PLATE [HW-7600]

DOUBLE-LOK PANEL

3/8"

MOISTURE BARRIER (NOT BY MBCI)

5/8" PLYWOOD MIN. (NOT BY MBCI)

10-12 x 1 PANCAKE HEAD SELF-TAPPER [FASTENER #13] @ 5'-0" O.C.

14-10 x 1 'TYPE A' SELF-TAPPER W/WASHER [FASTENER #18] @ 1'-0" O.C.

TRI-BEAD TAPE SEALER [HW-504]

1/4-14 x 1 SELF-DRILLER W/WASHER [FASTENER #1] (2) PER INSIDE CLOSURE

WOOD BLOCKING (NOT BY MBCI)

NOTE: REFERENCE TYPICAL TRIM LAP SECTIONS

0/0 DIMENSION (SEE PLAN)