

1/4-14 x 1 1/4 LONG-LIFE  
SELF-DRILLER W/WASHER  
[FASTENER #1E] (2) PER ENDLAP

1/4-14 x 1 LONG-LIFE  
'TYPE AB' SELF-TAPPER  
W/WASHER [FASTENER #2B]  
(9) PER ENDLAP

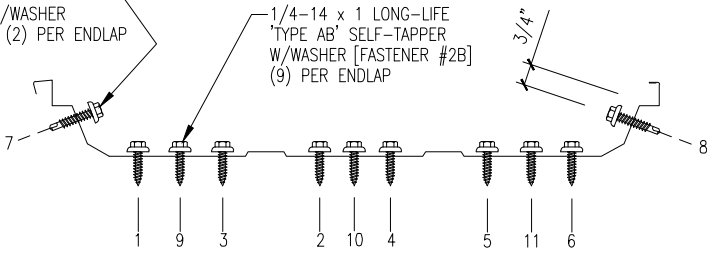

FASTENER SEQUENCE @ ENDLAP

1/4-14 x 1 LONG-LIFE  
'TYPE AB' SELF-TAPPER  
W/WASHER [FASTENER #2B]  
(9) PER 24" PANEL  
(5) PER 18" PANEL  
(4) PER 12" PANEL

DOUBLE-LOK PANEL  
(PRE-PUNCHED)

TRI-BEAD TAPE SEALER [HW-504]  
CONT. ACROSS PANEL OVER  
PRE-PUNCHED HOLES

NOTE:  
APPLY TRI-BEAD TAPE SEALER  
OVER THE NOTCHED PORTION  
OF THE MALE LEGS

14-10 x 1 'TYPE A'  
SELF-TAPPER W/WASHER  
[FASTENER #18]  
(2) PER INSIDE CLOSURE

METAL INSIDE CLOSURE  
[HW-426]

DOUBLE-LOK PANEL  
(PRE-PUNCHED)

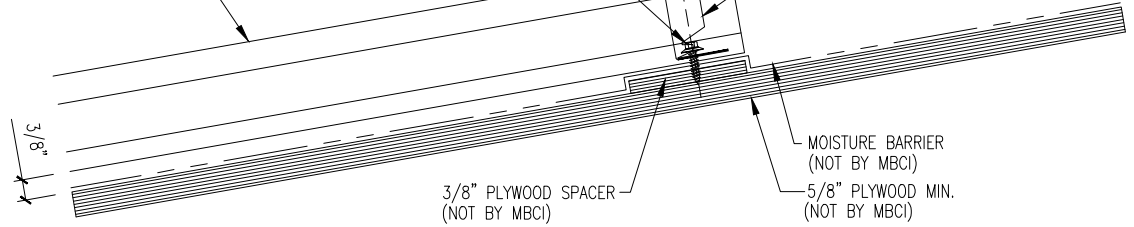

3/8" PLYWOOD SPACER  
(NOT BY MBCI)

MOISTURE BARRIER  
(NOT BY MBCI)  
5/8" PLYWOOD MIN.  
(NOT BY MBCI)

1/4-14 x 1 1/4 LONG-LIFE  
SELF-DRILLER W/WASHER  
[FASTENER #1E] (2) PER ENLAP

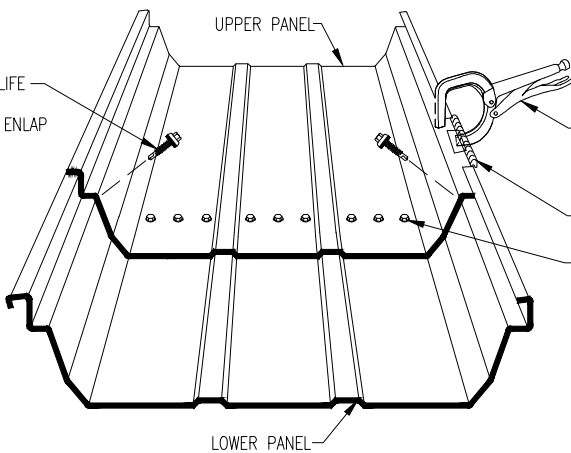

WISE GRIP®  
LOCKING PLIERS

TRI-BEAD TAPE SEALER  
[HW-504]

1/4-14 x 1 LONG-LIFE  
'TYPE AB' SELF-TAPPER  
W/WASHER [FASTENER #2B]  
(9) PER ENDLAP

PANEL INSTALLATION SEQUENCE