

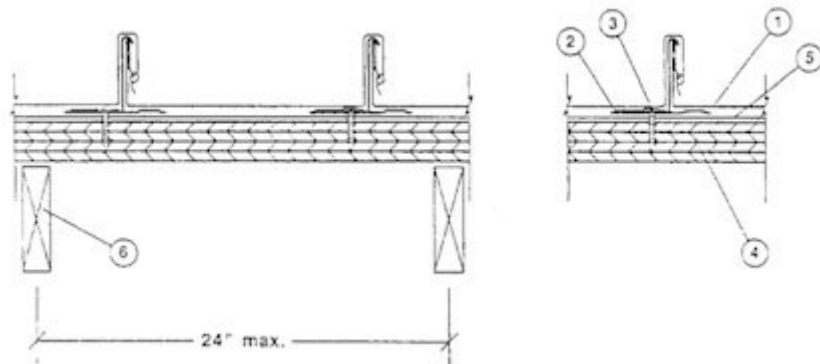

Construction No. 436

Uplift - Class 90

Fire Not Investigated



1. Metal Roof Deck Panels* No. 24 MSG min coated steel. Max panel width 18 in., rib height 1-3/4 in. Panels continuous over two or more spans. Endlap for panels to be overlapped 6 in. A bead of sealant may be used at panel ends and side joints.

- A&S BUILDING SYSTEMS, INC.-"LokSeam"
- MBCI--"LokSeam"
- MESCO METAL BUILDINGS-"LokSeam"
- NCI BUILDING SYSTEMS LP-"LokSeam"

2. Roof Deck Fasteners* - (Panel Clips) One piece assembly, 3-1/2 in. wide by 1-7/8 in. high. Clip spacing to be 48 in. OC.

- NCI BUILDING SYSTEMS LP-"LokSeam UL 90 Clip"

3. Fasteners - (Screws) Screws used to attach the panel clips to Substructure (Item 4) to be No. 10 by 1 in long Pancake head wood screws with a No. 2 Phillips head or 10x1 in., 1/4 in. Hex Head Woodgrip. Two screws per clip.

Screws used to attach Substructure (Item 4) to wood trusses or joists (Item 6) to be No. 8 by 2 in. Bugle head screws. As an optional fastener, 2-1/2 in. long 8d common deformed shank nails may be used. Fasteners used at endlaps to be 14x1 in. Type AB or 10x1 in. woodgrip.

When light gauge structural steel joists are used, screws to be No. 12 by 1-5/8 in. long with a Phillips head.

Spacing of screws to be 6 in. OC at plywood or OSB ends and 12 in. OC at interior joists.

4. Substructure (Plywood or OSB) Plywood decking or oriented strand board (OSB) to be a nom 5/8 in. thick, exposure sheathing span C-D, 40/20 plywood. (All butt joints to be sealed against leakage by using tape and/or caulking). In lieu of plywood, 1 in. tongue and groove decking may be used.

5. Moisture Barrier - (Optional) Any suitable membrane to protect Substructure (Item 4).

6. Joists--Joists, spaced at 2 ft, 0 in. OC max (when tongue and groove decking is used, joist spacing may be 30 in. OC max), may be one of the following:

A. Nom 2 by 6 in. wood joists, No. 2 or better.

B. Nom 2 by 4 in wood when used on a top chord of a wood truss, No. 2 or better.

C. Light gauge structural steel framing with the member against the plywood to be a min No. 22 MSG coated steel.

Refer to General Information, Roof Deck Construction, (Roofing Materials and Systems Directory) for Items Not Evaluated.

*Bearing the UL Classification Marking