

# SOFFITS

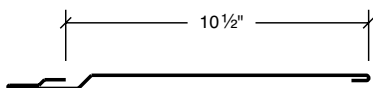

## FLEXLOC®

Available in 8½-inch, 9½-inch or 10½-inch widths, the FlexLoc® panel is clipped down to a waterproofed solid substrate, when used in roof applications.

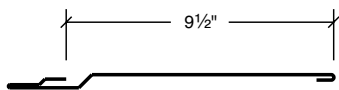
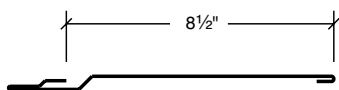
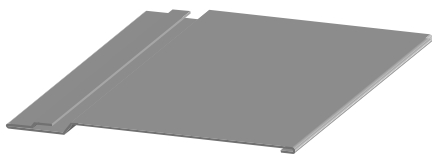

### Features and Benefits:

- Because the panels are generally run parallel to the curved surface, no pre-curved of the FlexLoc® panel is required.
- For the designer who wants a barrel vault with a smooth look (no standing seams) and horizontal lines instead of vertical, curved FlexLoc® is the recommended product. It's ideal for curved applications or soffits.
- FlexLoc® is a non-structural panel.

### Product Specifications

- **Applications:** Roof, Fascia, Soffit
- **Coverage Widths:** 8½", 9½", 10½"
- **Panel Attachment:** Concealed Fastening System
- **Gauges:** 24 (standard); 22 (optional)
- **Finishes:** Smooth (standard); Embossed (optional)
- **Coatings:** Galvalume Plus®, Signature® 200, Signature® 300, Signature® 300 Metallic

[www.mbc.com](http://www.mbc.com)

HOUSTON, TX | 877.713.6224  
ADEL, GA | 888.446.6224  
ATLANTA, GA | 877.512.6224

ATWATER, CA | 800.829.9324  
DALLAS, TX | 800.653.6224  
INDIANAPOLIS, IN | 800.735.6224

LUBBOCK, TX | 800.758.6224  
MEMPHIS, TN | 800.206.6224  
OKLAHOMA CITY, OK | 800.597.6224

OMAHA, NE | 800.458.6224  
PHOENIX, AZ | 888.533.6224  
RICHMOND, VA | 800.729.6224

ROME, NY | 800.559.6224  
SALT LAKE CITY, UT | 800.874.2404  
SAN ANTONIO, TX | 800.598.6224

**MBCT**  
Metal Roof and Wall Systems