

HIGH EAVE SEALANT DETAIL

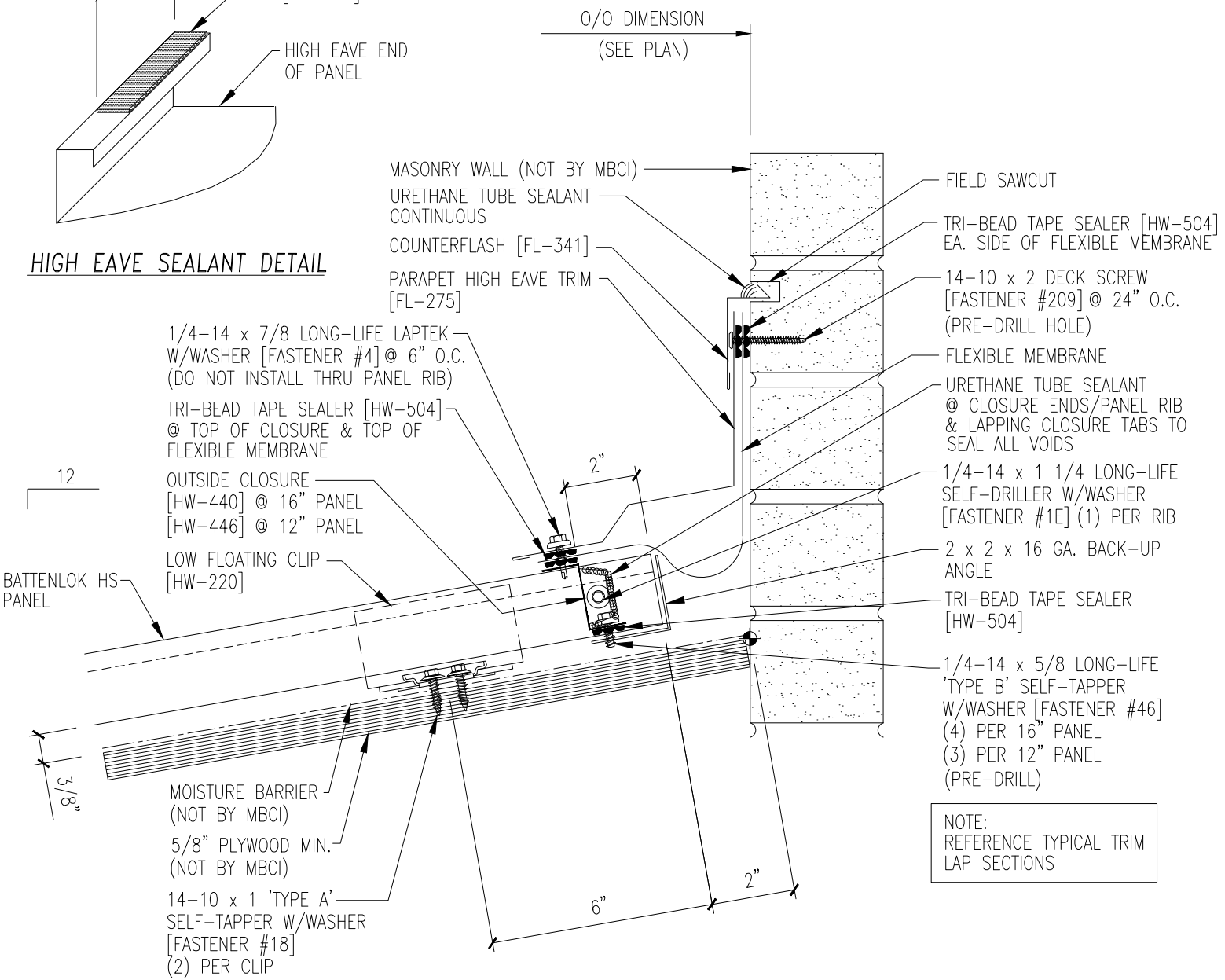

MASONRY WALL (NOT BY MBCI)
 URETHANE TUBE SEALANT CONTINUOUS
 COUNTERFLASH [FL-341]
 PARAPET HIGH EAVE TRIM [FL-275]

FIELD SAWCUT
 TRI-BEAD TAPE SEALER [HW-504] EA. SIDE OF FLEXIBLE MEMBRANE
 14-10 x 2 DECK SCREW [FASTENER #209] @ 24" O.C. (PRE-DRILL HOLE)
 FLEXIBLE MEMBRANE
 URETHANE TUBE SEALANT @ CLOSURE ENDS/PANEL RIB & LAPPING CLOSURE TABS TO SEAL ALL VOIDS
 1/4-14 x 1 1/4 LONG-LIFE SELF-DRILLER W/WASHER [FASTENER #1E] (1) PER RIB
 2 x 2 x 16 GA. BACK-UP ANGLE
 TRI-BEAD TAPE SEALER [HW-504]
 1/4-14 x 5/8 LONG-LIFE 'TYPE B' SELF-TAPPER W/WASHER [FASTENER #46] (4) PER 16" PANEL (3) PER 12" PANEL (PRE-DRILL)

1/4-14 x 7/8 LONG-LIFE LAPTEK W/WASHER [FASTENER #4] @ 6" O.C. (DO NOT INSTALL THRU PANEL RIB)
 TRI-BEAD TAPE SEALER [HW-504] @ TOP OF CLOSURE & TOP OF FLEXIBLE MEMBRANE

OUTSIDE CLOSURE [HW-440] @ 16" PANEL [HW-446] @ 12" PANEL

LOW FLOATING CLIP [HW-220]

12
 BATTENLOK HS PANEL

MOISTURE BARRIER (NOT BY MBCI)
 5/8" PLYWOOD MIN. (NOT BY MBCI)
 14-10 x 1 'TYPE A' SELF-TAPPER W/WASHER [FASTENER #18] (2) PER CLIP

NOTE:
 REFERENCE TYPICAL TRIM LAP SECTIONS

O/O DIMENSION (SEE PLAN)