

HIGH EAVE SEALANT DETAIL

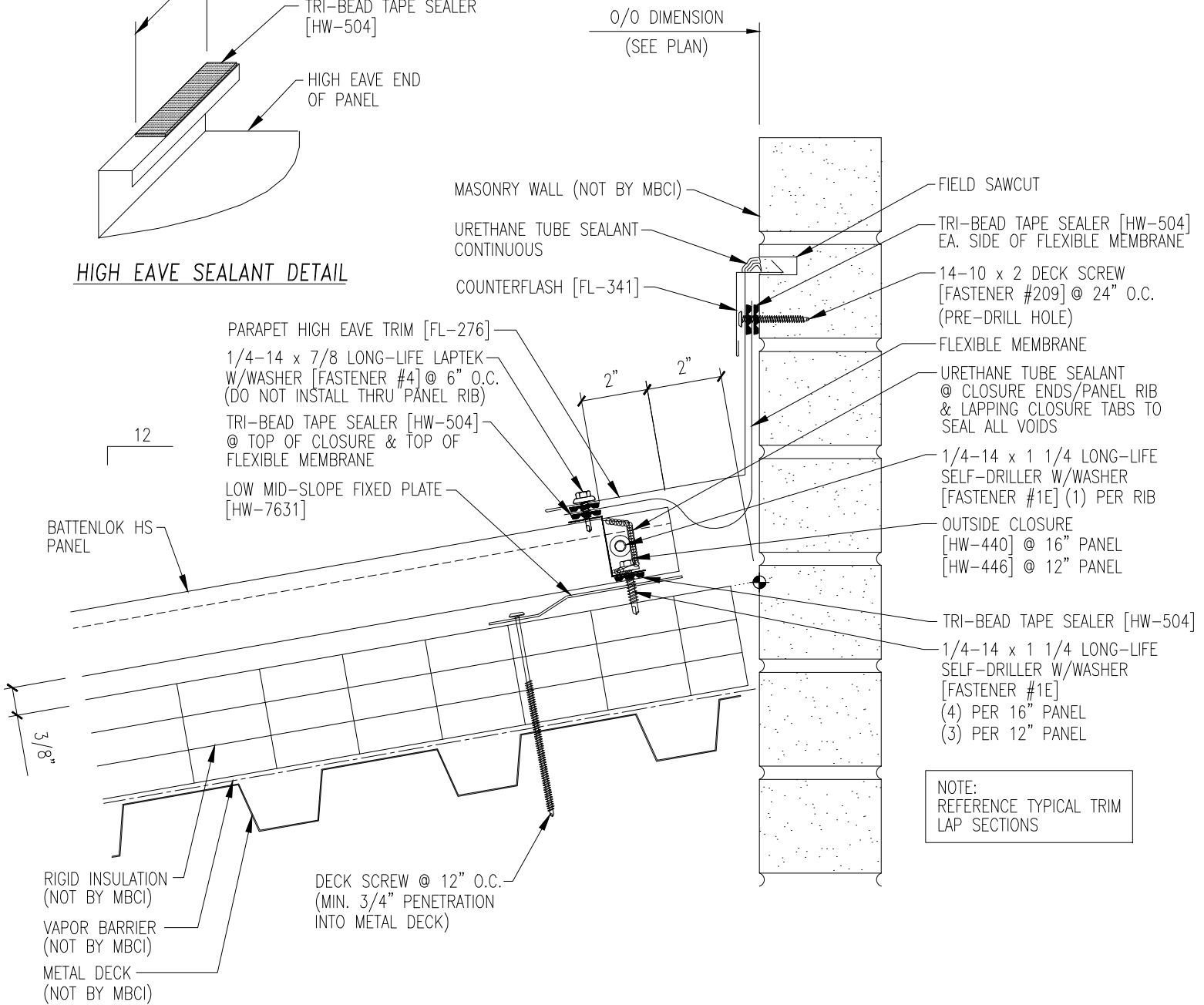

O/O DIMENSION
(SEE PLAN)

MASONRY WALL (NOT BY MBCI)

URETHANE TUBE SEALANT
CONTINUOUS

COUNTERFLASH [FL-341]

FIELD SAWCUT

TRI-BEAD TAPE SEALER [HW-504]
EA. SIDE OF FLEXIBLE MEMBRANE

14-10 x 2 DECK SCREW
[FASTENER #209] @ 24" O.C.
(PRE-DRILL HOLE)

FLEXIBLE MEMBRANE

URETHANE TUBE SEALANT
@ CLOSURE ENDS/PANEL RIB
& LAPPING CLOSURE TABS TO
SEAL ALL VOIDS

1/4-14 x 1 1/4 LONG-LIFE
SELF-DRILLER W/WASHER
[FASTENER #1E] (1) PER RIB

OUTSIDE CLOSURE
[HW-440] @ 16" PANEL
[HW-446] @ 12" PANEL

TRI-BEAD TAPE SEALER [HW-504]

1/4-14 x 1 1/4 LONG-LIFE
SELF-DRILLER W/WASHER
[FASTENER #1E]
(4) PER 16" PANEL
(3) PER 12" PANEL

PARAPET HIGH EAVE TRIM [FL-276]

1/4-14 x 7/8 LONG-LIFE LAPTEK
W/WASHER [FASTENER #4] @ 6" O.C.
(DO NOT INSTALL THRU PANEL RIB)

TRI-BEAD TAPE SEALER [HW-504]
@ TOP OF CLOSURE & TOP OF
FLEXIBLE MEMBRANE

LOW MID-SLOPE FIXED PLATE
[HW-7631]

12

BATTENLOK HS
PANEL

RIGID INSULATION
(NOT BY MBCI)

VAPOR BARRIER
(NOT BY MBCI)

METAL DECK
(NOT BY MBCI)

DECK SCREW @ 12" O.C.
(MIN. 3/4" PENETRATION
INTO METAL DECK)

3/8"

2" 2"

NOTE:
REFERENCE TYPICAL TRIM
LAP SECTIONS