

FASTENER SEQUENCE @ EAVE

12

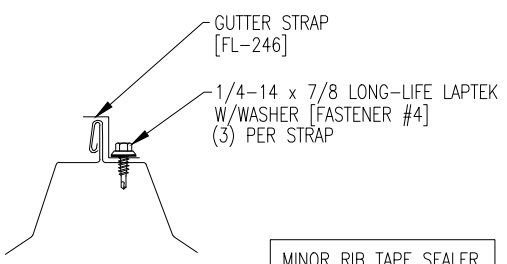

MINOR RIB TAPE SEALER AT ALL MINOR RIBS [HW-512]

TRI-BEAD TAPE SEALER [HW-504] @ TOP OF CLOSURE
 1/4-14 x 7/8 LONG-LIFE LAPTEK W/WASHER [FASTENER #4] (3) PER STRAP

PREPUNCHED HOLES IN PANEL

E.H. = ?'-?"
 1/4-14 x 7/8 LONG-LIFE LAPTEK W/WASHER [FASTENER #4] @ 12" O.C.
 BOX PANEL CAP TRIM [FL-272]
 12-14 x 1 1/4 LONG-LIFE SELF-DRILLER W/WASHER [FASTENER #3]
 1/8 x 3/16 POP RIVET [FASTENER #14] @ 3'-0" O.C.
 SCULPTURED GUTTER [FL-241A]

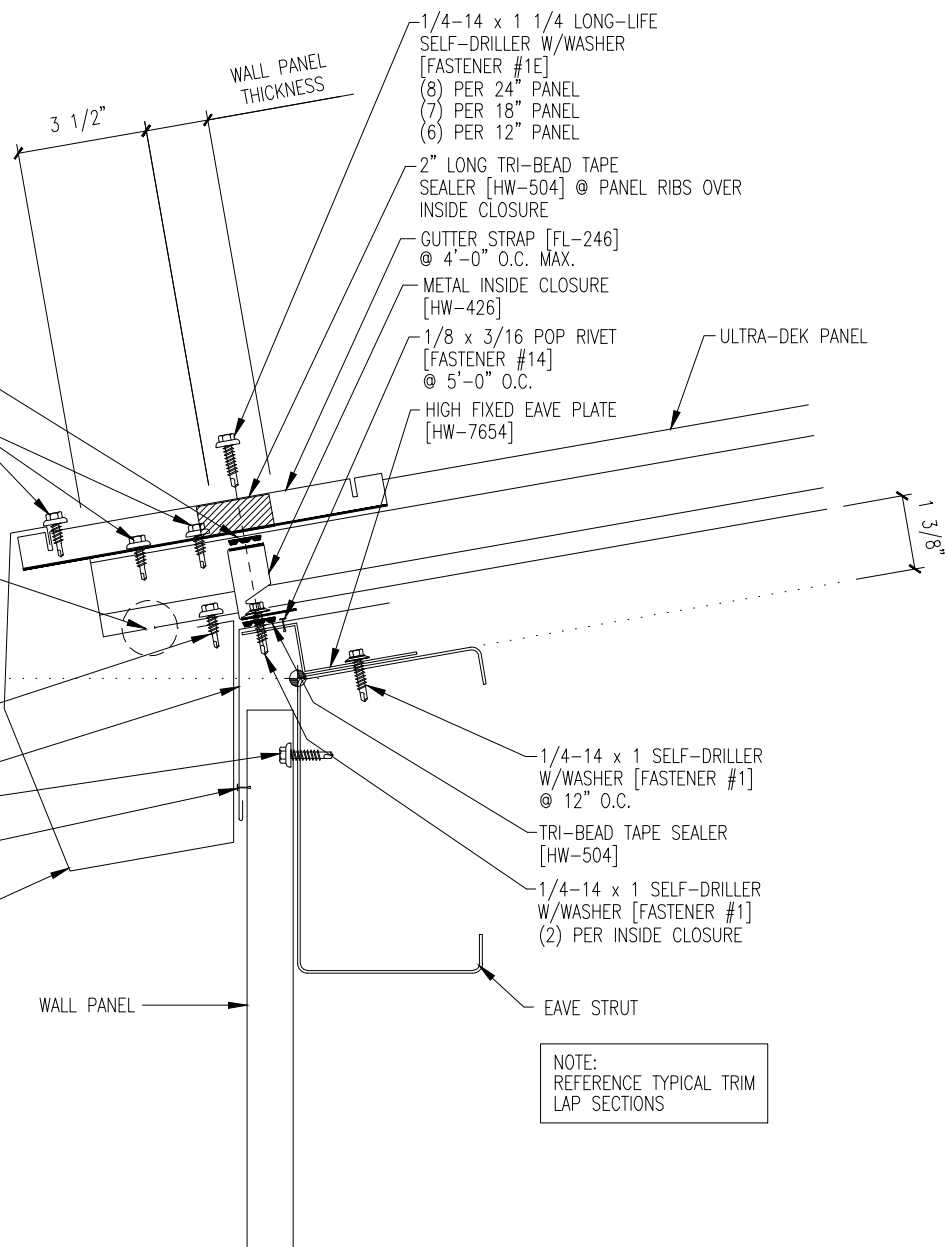

NOTE: REFERENCE TYPICAL TRIM LAP SECTIONS

O/O DIMENSION (SEE PLAN)