

1/4-14 x 1 1/4 LONG-LIFE SELF-DRILLER W/WASHER [FASTENER #1E]

**FASTENER SPACING @ EAVE**

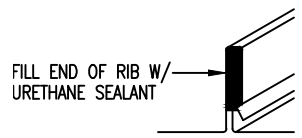

FILL END OF RIB W/ URETHANE SEALANT

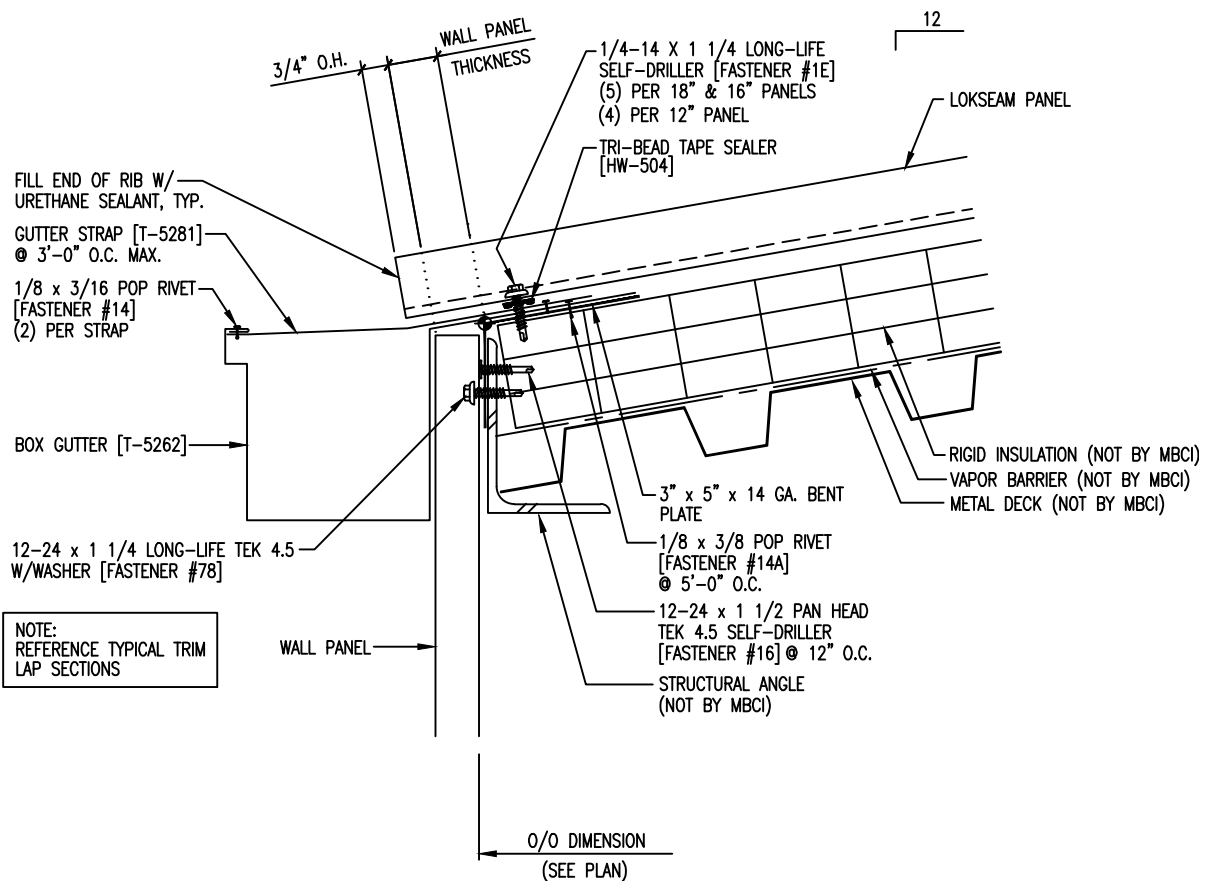

FILL END OF RIB W/ URETHANE SEALANT, TYP.  
 GUTTER STRAP [T-5281] @ 3'-0" O.C. MAX.  
 1/8 x 3/16 POP RIVET [FASTENER #14] (2) PER STRAP

BOX GUTTER [T-5262]  
 12-24 x 1 1/4 LONG-LIFE TEK 4.5 W/WASHER [FASTENER #78]

NOTE: REFERENCE TYPICAL TRIM LAP SECTIONS

3/4" O.H. WALL PANEL THICKNESS

1/4-14 X 1 1/4 LONG-LIFE SELF-DRILLER [FASTENER #1E] (5) PER 18" & 16" PANELS (4) PER 12" PANEL

TRI-BEAD TAPE SEALER [HW-504]

12 LOKSEAM PANEL

3" x 5" x 14 GA. BENT PLATE

1/8 x 3/8 POP RIVET [FASTENER #14A] @ 5'-0" O.C.

12-24 x 1 1/2 PAN HEAD TEK 4.5 SELF-DRILLER [FASTENER #16] @ 12" O.C.

STRUCTURAL ANGLE (NOT BY MBCI)

RIGID INSULATION (NOT BY MBCI)  
 VAPOR BARRIER (NOT BY MBCI)  
 METAL DECK (NOT BY MBCI)

O/O DIMENSION (SEE PLAN)