

SOFFITS



FLEXLOC®

Available in a 9½-inch width, the FlexLoc® panel is clipped down to a waterproofed solid substrate, when used in roof applications.

Features and Benefits:

- For the designer who wants a barrel vault with horizontal lines and a smooth look (no standing seams), FlexLoc® is the recommended product for applications with a minimum of a 10'-0" radius.
- Because the panels are generally installed horizontally following the curved surface, pre-curving of the FlexLoc® panel is not required or offered.
- FlexLoc® is a non-structural panel.
- Download the manual for factory curved rake trim and other product checklist accessories
- For continuous panel applications over 20'-0", please inquire.

Product Specifications

- **Applications:** Roof, Fascia, Soffit
- **Coverage Widths:** 9½"
- **Panel Attachment:** Concealed Fastening System
- **Gauges:** 24 (standard); 22 (optional)
- **Finishes:** Smooth (standard); Embossed (optional)
- **Coatings:** Galvalume Plus®, Signature® 200, Signature® 300, Signature® 300 Metallic

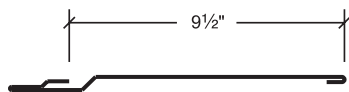
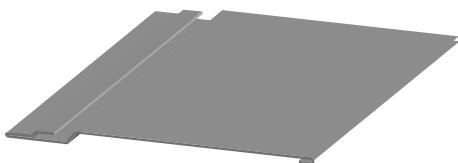

Descriptions and specifications contained herein were in effect at the time this publication was approved for printing. In a continuing effort to refine and improve products, MBCI reserves the right to discontinue products at any time or change specifications and/or designs without incurring obligation. To ensure you have the latest information available, please inquire or visit our website at www.mbc.com. Application details are for illustration purposes only and may not be appropriate for all environmental conditions, building designs or panel profiles. Projects should be designed to conform to applicable building codes, regulations and accepted industry practices. If there is a conflict between this manual and project erection drawings, the erection drawings will take precedence. MBCI's insulated metal panel product line is manufactured by Metl-Span®. © 2020 MBCI®, part of the Cornerstone Building Brands family. All rights reserved. 0706209991103/RevA/MS/0720