

CONCEALED FASTENING SYSTEMS

FW-120 PANEL

The FW-120 panel is a concealed fastener wall and liner panel that provides a flat appearance. FW-120 is commonly used for architectural, commercial and industrial markets. The heavy gauge offering provides for large spanning capabilities, particularly in composite wall applications.

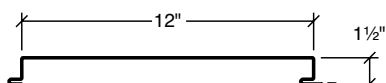
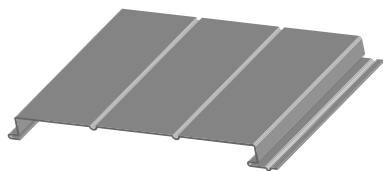

FW-120-0

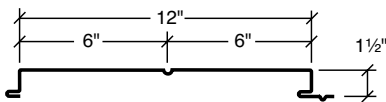

FW-120-1
with Bead

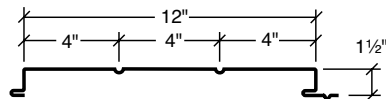

FW-120-2
with Beads

Features and Benefits:

- FW-120 is available in a flat profile with no beads, one bead or two beads.
- The FW-120 Panel has been tested by a certified independent laboratory in accordance with ASTM test procedures for Air Infiltration and Water Penetration at the sidelap. Test results show no air leakage at 1.57PSF and no water penetration at 6.24PSF differential pressure.
- FW-120 carries Florida approval.

Product Specifications

- **Applications:** Wall and Fascia
- **Coverage Widths:** 12"
- **Panel Attachment:** Concealed Fastening System
- **Gauges:** 24 (standard); 22 and 20 (optional)
- **Finishes:** Smooth (standard); Embossed (optional)
- **Coatings:** Signature® 300

www.mbc.com

HOUSTON, TX | 877.713.6224
ADEL, GA | 888.446.6224
ATLANTA, GA | 877.512.6224

ATWATER, CA | 800.829.9324
DALLAS, TX | 800.653.6224
INDIANAPOLIS, IN | 800.735.6224

LUBBOCK, TX | 800.758.6224
MEMPHIS, TN | 800.206.6224
OKLAHOMA CITY, OK | 800.597.6224

OMAHA, NE | 800.458.6224
PHOENIX, AZ | 888.533.6224
RICHMOND, VA | 800.729.6224

ROME, NY | 800.559.6224
SALT LAKE CITY, UT | 800.874.2404
SAN ANTONIO, TX | 800.598.6224

MBCI
Metal Roof and Wall Systems

CONCEALED FASTENING SYSTEM

FW-120 PANEL

CATEGORY	CHARACTERISTIC	TEST METHOD	PURPOSE	RESULT
ENVIRONMENTAL	Air leakage	ASTM E283	Determines the air leakage rates of exterior windows, curtain walls, and doors under specified air pressure differences across the specimen	0.000 cfm/ft ² at 6.24 psf static pressure 0.113 cfm/ft ² at 20.00 psf static pressure
	Water Penetration	ASTM E331	Determines the resistance of exterior windows, curtain walls, skylights, and doors to water penetration when water is applied under uniform static air pressure difference	No uncontrolled water penetration through the panel joints at a static pressure of 13.24 psf
STRUCTURAL	Negative Wind Loads	ASTM E 1592	Provides a standard procedure to evaluate or confirm structural performance under uniform static air pressure difference	See Load Chart Section
	Positive Wind Load	AISI S100	North American Specification for the Design of Cold-Formed Steel Structural Members	See Section Properties and Allowable Load Table Section
ROOF LISTINGS	Roof Performance - Florida Approval	ASTM E 1592	Florida product approval is the approval of products and systems, which comprise the building envelope and structural frame, for compliance with the structural requirements of the Florida Building Code.	See FL# 11917.3